

**SUNFLEX UK** 

# Technical Manual - SVG20/30 Twin Track



Standard Colours	
Frame	RAL 7016 Anthracite Grey in matt finish DB703 Charcoal Grey Metallic in textured finish RAL 9005 Jet Black in matt finish
200 Non-standard RAL colours and marine finish available	
Dual colour available but colour on opposite side can be seen when doors are open or closed, please ask for photos of this if required	
Bar Handles	Colour matched to door colour or Stainless Steel
Recessed Handles	Colour matched to door colour
D Handles	Colour matched to door colour

Maximums & Minimums*			
Minimum Door Panel Width	Maximum Door Panel Width	Minimum Door Panel Height	Maximum Door Panel Height
800mm	3000mm	1000mm	3000mm
*Please refer to SVG20 & SVG30 maximum panel sizes based upon site exposure on page 9			
Maximum weight per door panel is 250KG			

Thermal performance		
Glass thickness Options	36mm or 36.8mm	
Centre Pane	Example of glass	Overall U-value
1.0 W/m <sup>2</sup> k Double glazed	6mm toughened x 24mm Argon x 6mm toughened soft coat coat	from 1.4 W/m <sup>2</sup> k
0.7 W/m <sup>2</sup> k Double glazed	6mm toughened x 24mm Argon x 6mm toughened CUIN Ultra	from 1.2 W/m <sup>2</sup> k

Security	
Locking	Multipoint locking system with hook lock and cams
	Concealed Anti Lift Blocks
	Key locking, 6 Pin, Anti Bump, Anti-Snap, Anti-Drill
Accreditations	PAS 24:2022 certification* (P1a Security Glass Required)
	Secure By Design™* (P1a Security Glass Required)

Weather performance*	
Water Tightness BS EN 12208	300 Pa. (Class 7a)
Air Permeability BS EN 12207	600 Pa. (Class 3)
Wind resistance	1700 Pa. (Class C4)
*Dependant on size and style, please contact Sunflex UK for specific results.	
Trickle Vent Options	4000mm <sup>2</sup> or 8000mm <sup>2</sup> Airflow in 40mm Add Ons
Sill Options (see page 10 for further details)	190mm x 25mm
	228mm x 25mm
Heritage Style (See page 19 for further details)	30mm Plant on bar
	70mm Midrail

## SVG20 & SVG30 Key Features

### Ultra Slim but not a structurally bonded sliding door

Unlike most ultra slim sliding doors other companies supply, the SVG20 & SVG30 doors are not structurally bonded to the glass. If the glass was structurally bonded to the doors replacing or upgrading the glass in the future would mean buying a new door panel as well, or a whole new set of doors if that door is no longer made. Sunflex UK are proud to not sell structurally bonded sliding doors providing its customers with long term peace of mind. For more information, please read our blog -

<https://sunflexuk.co.uk/help-advice/structurally-bonded-glass-know-the-risks-when-choosing-a-sliding-door/>

When the SVG doors are open the door panels stack neatly, flush, in line with each other. Such a neat detail and a contemporary appearance. Most sliding doors from other companies are staggered when open, not as neat or as well designed.

### Flush Stacking Panels

### Slim From Any Angle sliding door

The SVG20 has a 20mm sight line and the SVG30 has a 30mm sight line. The SVG doors are designed without the need for any external reinforcing profile or a chunky frame that extends away from the glass. The SVG doors are slim from any angle, not just face on. Only 59mm front to back no matter the size of the doors. When choosing a sliding door always check the depth of the interlock, how this will look from an angle, not just the straight on sightline.

Sunflex UK have been manufacturing and supplying sliding doors across the UK for over 20 years. Over this time the SVG doors have had continuous updates and innovations, and you can benefit from the tried and tested finished product. Every Sunflex UK SVG door is made in the Sunflex UK manufacturing plant. Sunflex UK supplies to a hand selected network of distributors across the UK to ensure the best possible service and complete peace of mind.

### Complete Peace Of Mind

### Advanced Performance Quad Wheel Carriage

Over the past 20 years Sunflex UK have learned that the most crucial part of any sliding door is the wheel carriage the doors run on. This is the engine of the sliding doors and will dictate how smoothly the doors slide and how long the doors will last. When choosing a sliding door compare what the wheel carriage looks like and what the wheels are made of. Other sliding doors have plastic wheels or just a 2 wheel carriage. The Sunflex UK SVG doors have 4 wheels on each running carriage, made of stainless-steel running on a stainless steel track, perfect for smooth sliding and longevity.

The door handle can make or break the look of a sliding door. Not only must these look good they must also be a pleasure to use. The SVG doors have a range of handle styles, either colour matched to the doors or in stainless steel.

### Handle Options

### Range of opening Styles

The SVG doors have a range of opening styles. Pocket doors providing a 100% clear opening, open corners for a seamless transition between inside and outside, frameless corners for dual aspect views. You can combine the open corners with pocket doors for a real wow factor and the centre piece of your build.

The SVG sliding doors hold the prestigious Secured By Design award, a police security initiative. A continuous 6-point locking system with concealed anti-lift blocks. PAS24 compliant meeting the requirements of building regulations Part Q and a 6-pin anti-bump, anti-snap, anti-drill key cylinder exceeding British insurance requirements of BS3621.

### Security

# Standard Configurations

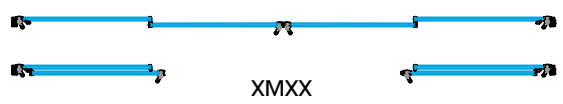
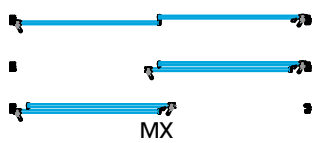
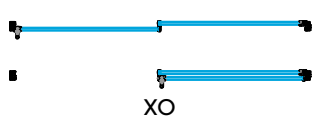

Key-  
X= Sliding  
M=Main sliding on inner track  
O= Fixed panel  
OLO= Centre door sliding Left  
ORO= Centre door sliding Right

Note:-  
For Corner and Pocket options please see  
corner and pocket technical manual

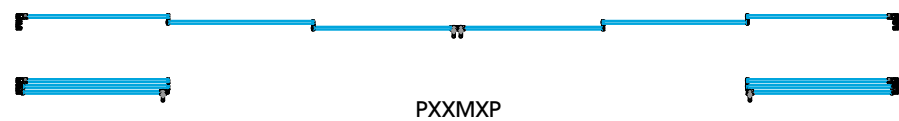
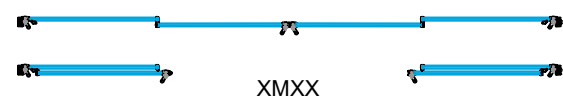
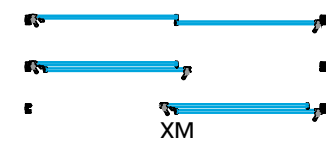
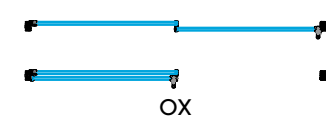



# Flush Stacking Panels

2 Doors, 1 Sliding, 1 Fixed (XO)

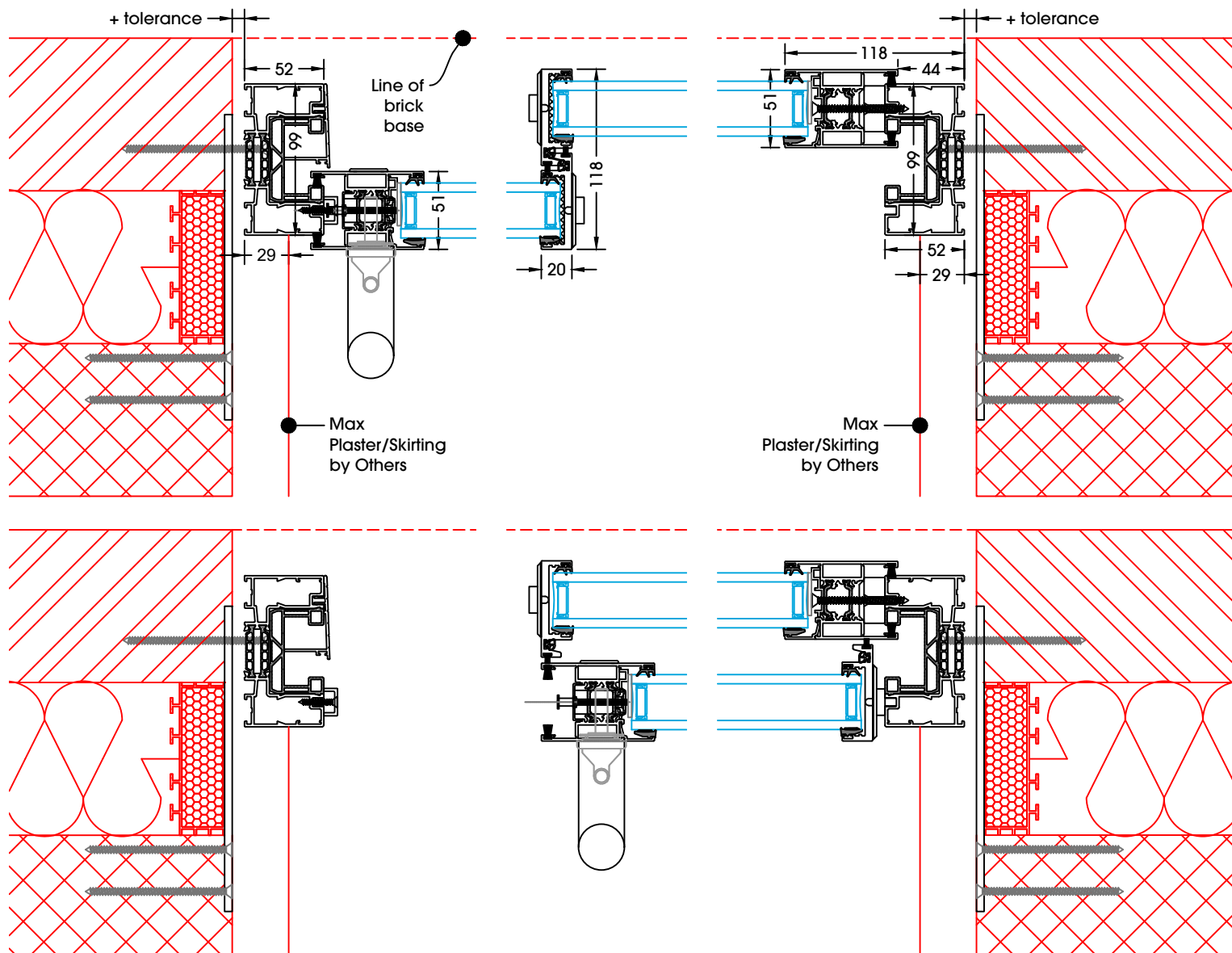

## Flush Stacking Panels When Open

The SVG20 & SVG30 can provide flush stacking panels when open. Such a neat design compared to many other sliding doors that must be staggered when open. To achieve this the protruding handle and lock must be on the inside only, colour matched recessed handle can be on the outside. There should also be a fixed door panel. A fixed door panel also allows the colour matched treadplates to be used on the outside tracks for a neater look.

## Flush Stacking Panels When Open (All Panels Sliding)

When all doors slide, flush stacking panels are only possible with a protruding handle and key lock on the inside only of the inner panel and outside only of the external panel. The doors would flush stack to one side only, when the panel on the inner track opens to the opposite side.

# Flush Stacking Panels

## 2 Sliding Doors, 1 Plant-on panel (XXP)

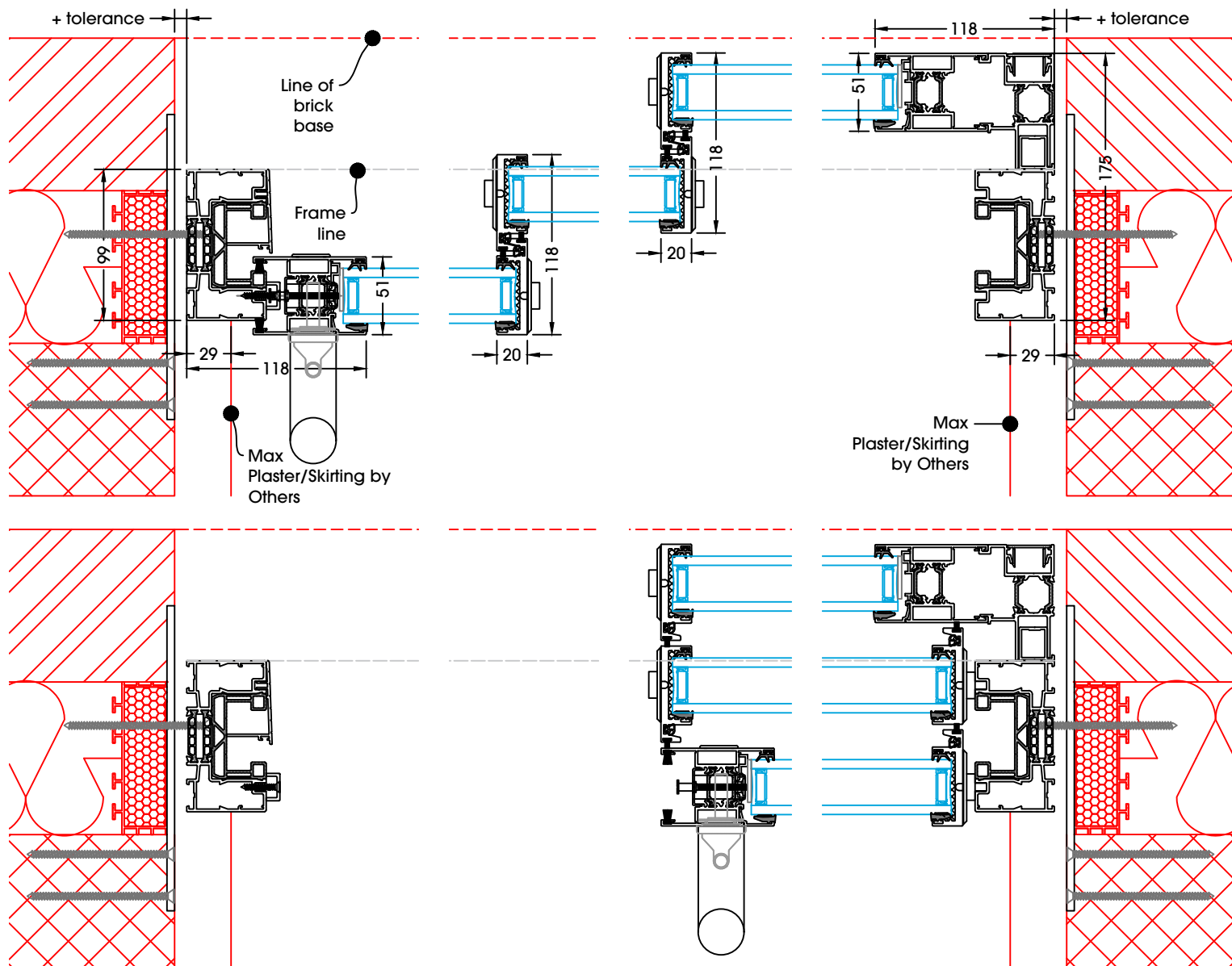

### Flush Stacking Panels When Open

The SVG20 & SVG30 can provide flush stacking panels when open. Such a neat design compared to many other sliding doors that must be staggered when open. To achieve this the protruding handle and lock must be on the inside only, colour matched recessed handle can be on the outside. There should also be a fixed door panel. A fixed door panel also allows the colour matched treadplates to be used on the outside tracks for a neater look.

### Flush Stacking Panels When Open (All Panels Sliding)

When all doors slide, flush stacking panels are only possible with a protruding handle and key lock on the inside only of the inner panel and outside only of the external panel. The doors would flush stack to one side only, when the panel on the inner track opens to the opposite side.

# Flush Stacking Panels

1 Fixed, 1 Sliding Door (Main Panel), 1 Sliding Door, 1 Fixed (OMXO)

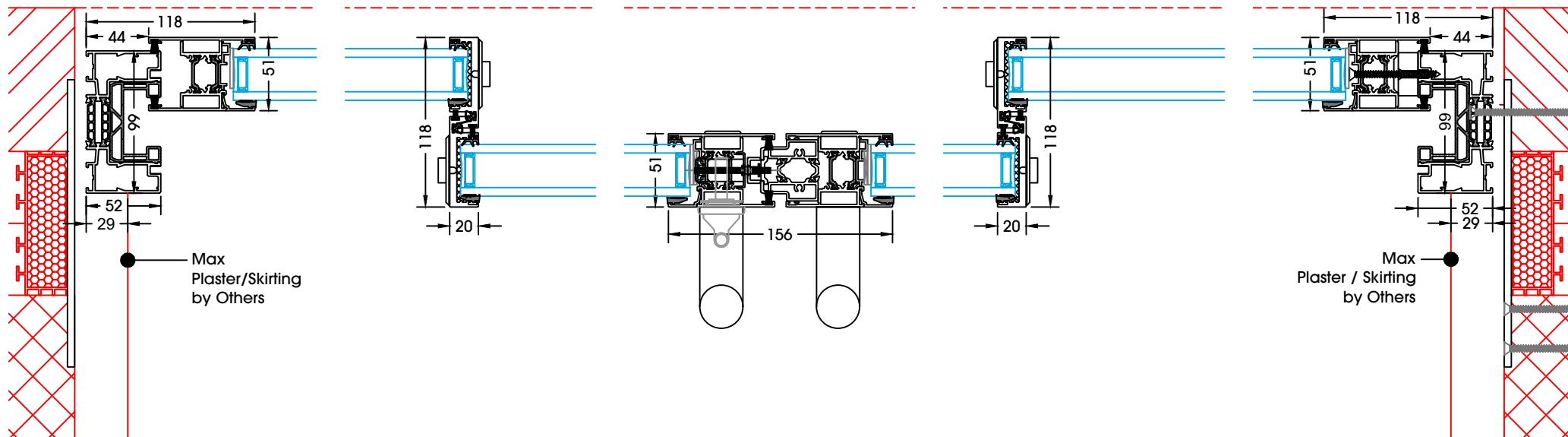

## Flush Stacking Panels When Open

The SVG20 & SVG30 can provide flush stacking panels when open. Such a neat design compared to many other sliding doors that must be staggered when open. To achieve this the protruding handle and lock must be on the inside only, colour matched recessed handle can be on the outside. There should also be a fixed door panel. A fixed door panel also allows the colour matched treadplates to be used on the outside tracks for a neater look.

## Flush Stacking Panels When Open (All Panels Sliding)

When all doors slide, flush stacking panels are only possible with a protruding handle and key lock on the inside only of the inner panel and outside only of the external panel. The doors would flush stack to one side only, when the panel on the inner track opens to the opposite side.

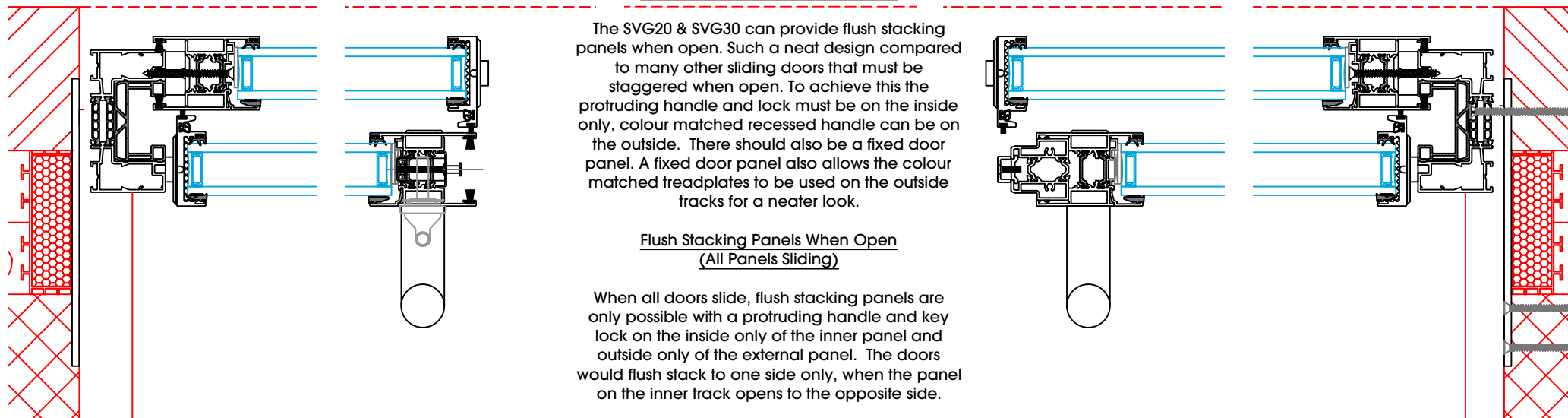

# Flush Stacking Panels

## Both Sliding Doors, One Main Panel (MX)

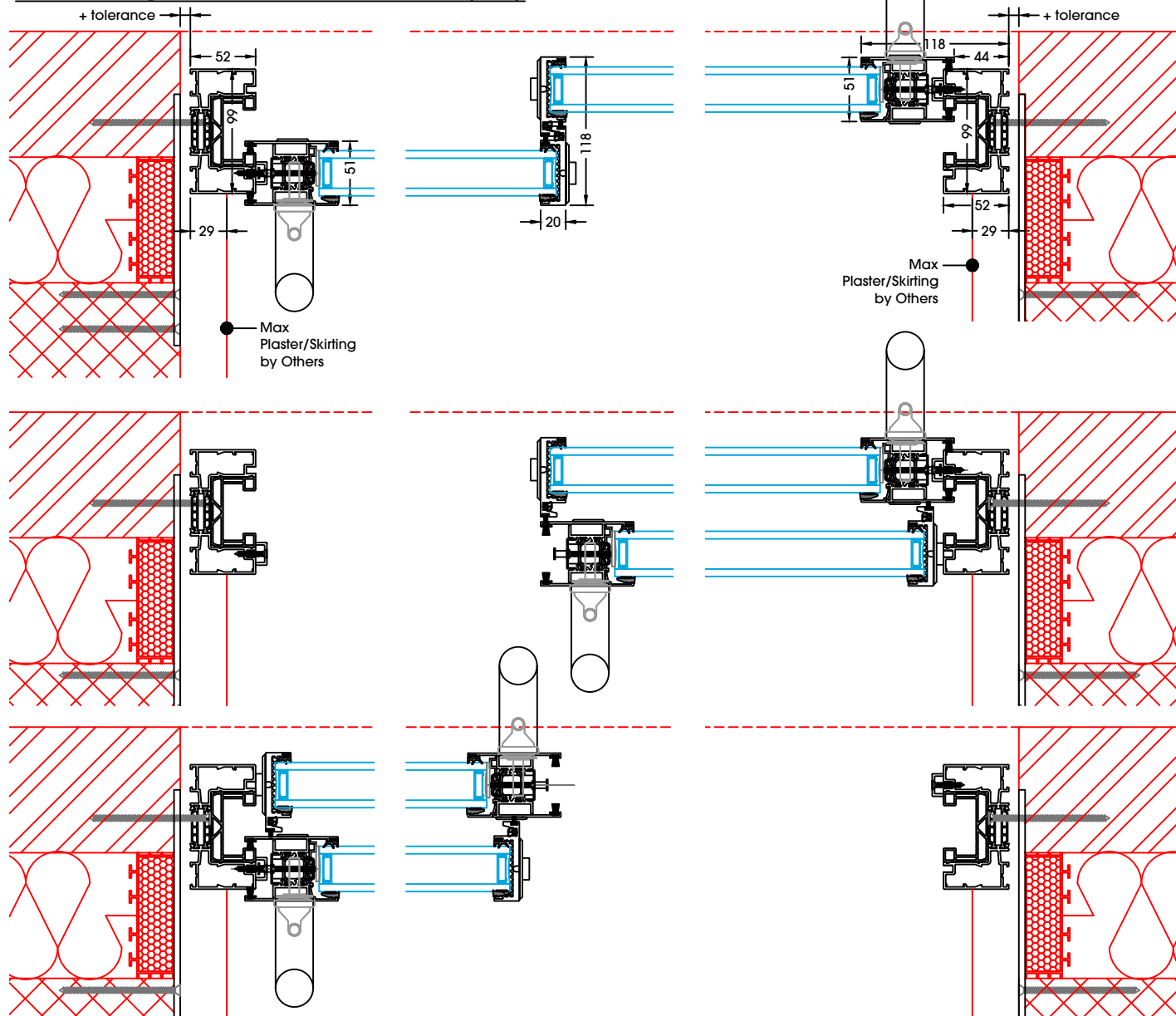

### Flush Stacking Panels When Open

The SVG20 & SVG30 can provide flush stacking panels when open. Such a neat design compared to many other sliding doors that must be staggered when open. To achieve this the protruding handle and lock must be on the inside only, colour matched recessed handle can be on the outside. There should also be a fixed door panel. A fixed door panel also allows the colour matched treadplates to be used on the outside tracks for a neater look.

### Flush Stacking Panels When Open (All Panels Sliding)

When all doors slide, flush stacking panels are only possible with a protruding handle and key lock on the inside only of the inner panel and outside only of the external panel. The doors would flush stack to one side only, when the panel on the inner track opens to the opposite side.



Maximum Glazing Weight per M<sup>2</sup> shown below. Max Panel Weight 250kg. please check with your glass supplier for there glass paramaters

### SVG30 Max Panel Sizes

3000	55kg	55kg	55kg	55kg	55kg	55kg	50kg	45kg	45kg	40kg	40kg										
2900	55kg	55kg	55kg	55kg	55kg	55kg	50kg	50kg	45kg	45kg	40kg	40kg									
2800	55kg	55kg	55kg	55kg	55kg	55kg	50kg	45kg	45kg	40kg	40kg	40kg									
2700	55kg	55kg	55kg	55kg	55kg	55kg	50kg	45kg	45kg	45kg	40kg	40kg	40kg								
2600	55kg	55kg	55kg	55kg	55kg	55kg	55kg	50kg	50kg	45kg	45kg	40kg	40kg								
2500	55kg	55kg	55kg	55kg	55kg	55kg	55kg	50kg	50kg	50kg	45kg	45kg	40kg	40kg							
2400	55kg	55kg	55kg	55kg	55kg	55kg	55kg	50kg	50kg	50kg	50kg	45kg	45kg	40kg	40kg						
2300	55kg	55kg	55kg	55kg	55kg	55kg	55kg	50kg	50kg	50kg	50kg	50kg	45kg	45kg	45kg	40kg	40kg				
2200	55kg	55kg	55kg	55kg	55kg	55kg	55kg	55kg	50kg	55kg	50kg	50kg	50kg	45kg	45kg	45kg	40kg	40kg	40kg	40kg	
2100	55kg	55kg	55kg	55kg	55kg	55kg	55kg	55kg	55kg	55kg	55kg	50kg	50kg	50kg	50kg	45kg	40kg	40kg	40kg	40kg	40kg
2000	55kg	55kg	55kg	55kg	55kg	55kg	55kg	55kg	55kg	55kg	55kg	55kg	55kg	50kg	50kg	50kg	45kg	40kg	40kg	40kg	40kg
	1000	1100	1200	1300	1400	1500	1600	1700	1800	1900	2000	2100	2200	2300	2400	2500	2600	2700	2800	2900	3000

Maximum Glazing Weight per M<sup>2</sup> shown below. Max Panel Weight 250kg. please check with your glass supplier for there glass paramaters

### SVG20 Max Panel Sizes

3000	55kg	55kg																			
2900	55kg	55kg	55kg																		
2800	55kg	55kg	55kg	55kg	55kg																
2700	55kg	55kg	55kg	55kg	55kg	55kg	55kg														
2600	55kg	55kg	55kg	55kg	55kg	55kg	55kg	55kg	50kg												
2500	55kg	55kg	55kg	55kg	55kg	55kg	55kg	55kg	50kg	50kg	50kg	45kg									
2400	55kg	55kg	55kg	55kg	55kg	55kg	55kg	55kg	50kg	50kg	50kg	50kg	45kg	45kg	45kg						
2300	55kg	55kg	55kg	55kg	55kg	55kg	55kg	55kg	50kg	50kg	50kg	50kg	50kg	45kg	45kg	40kg					
2200	55kg	55kg	55kg	55kg	55kg	55kg	55kg	55kg	55kg	50kg	55kg	50kg	50kg	45kg	45kg	45kg	40kg	40kg	40kg	40kg	
2100	55kg	55kg	55kg	55kg	55kg	55kg	55kg	55kg	55kg	55kg	55kg	55kg	50kg	50kg	50kg	45kg	45kg	40kg	40kg	40kg	40kg
2000	55kg	55kg	55kg	55kg	55kg	55kg	55kg	55kg	55kg	55kg	55kg	55kg	55kg	50kg	50kg	50kg	45kg	40kg	40kg	40kg	40kg
	1000	1100	1200	1300	1400	1500	1600	1700	1800	1900	2000	2100	2200	2300	2400	2500	2600	2700	2800	2900	3000

Suitable for wind pressure up to 750 Pascals.

Suitable for wind pressure up to 1200 Pascals.

Suitable for wind pressure up to 1700 Pascals.

(Contact Sunflex UK with post code and building height for an indication of expected wind pressure or check with structural engineer / architectetc.)

Minimum of 6mm thick glass required.

Any heights over 2500mm should be using 8mm glass units to prevent glass bowing.

Spacer bar to project no more than 12mm into unit

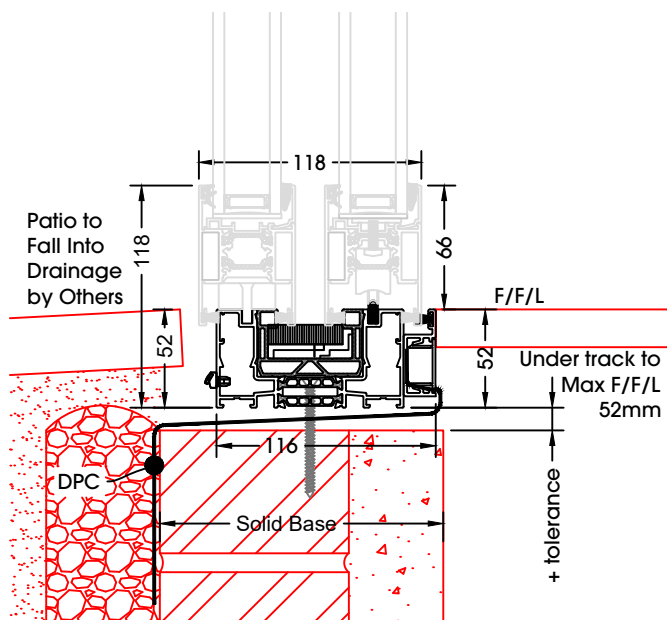

Twin track with flush floor detail inside

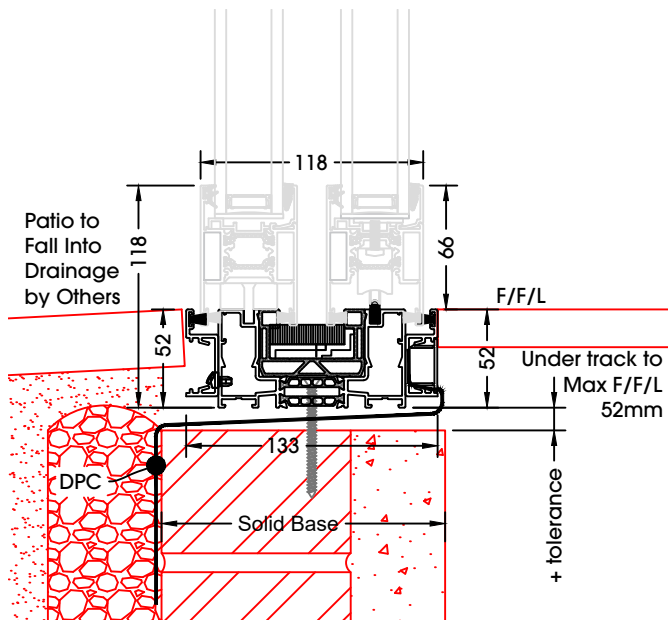

Twin track with flush floor detail both sides

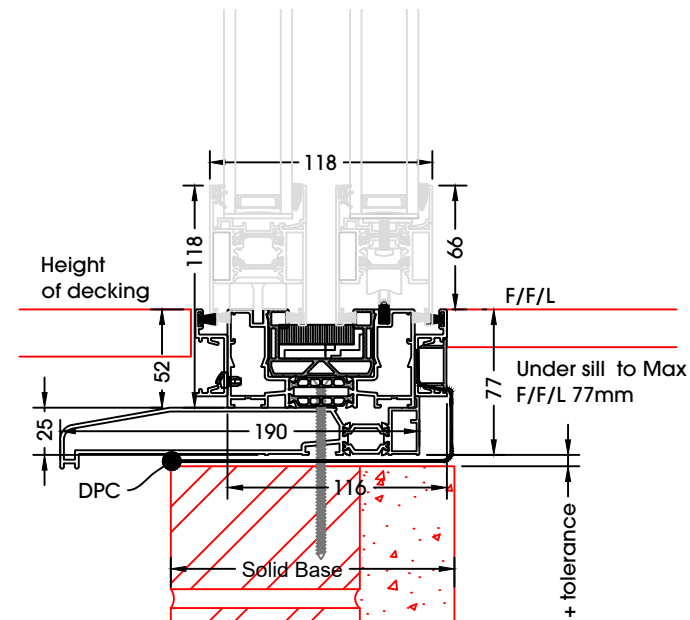

Twin track with flush floor detail both sides on a sill

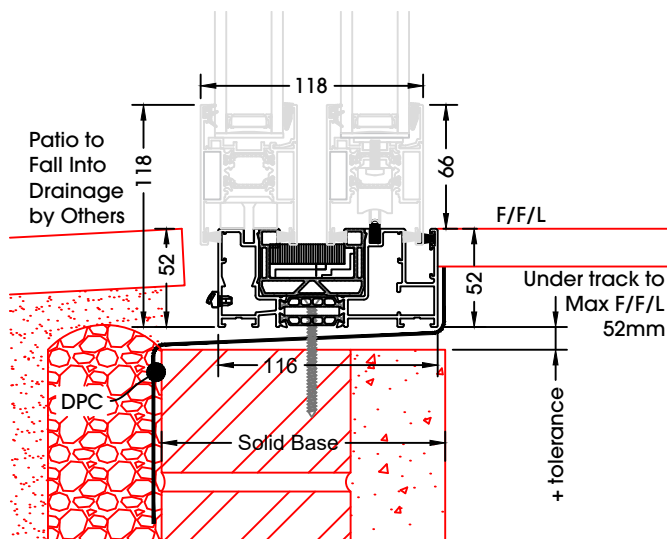

Twin track with flush detail all round inside

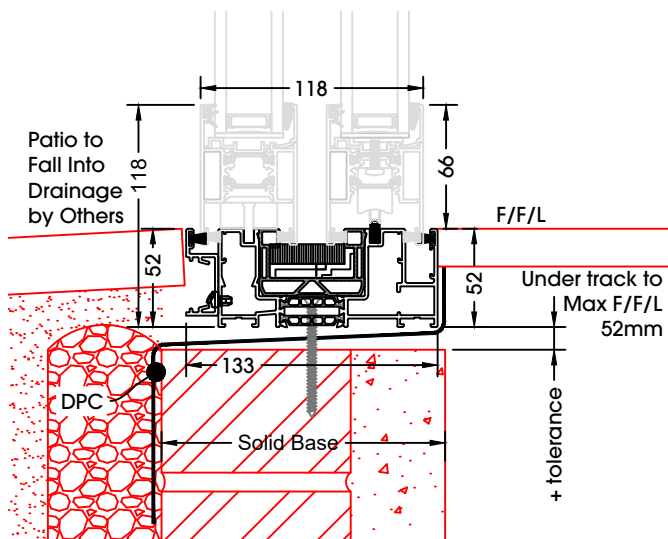

Twin track with flush detail all round inside and flush detail on outside

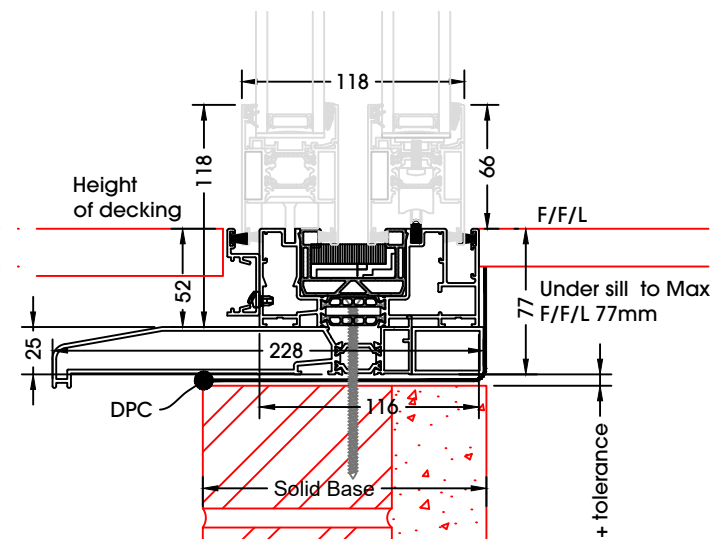

Twin track with flush detail all round inside and flush detail on outside on a sill

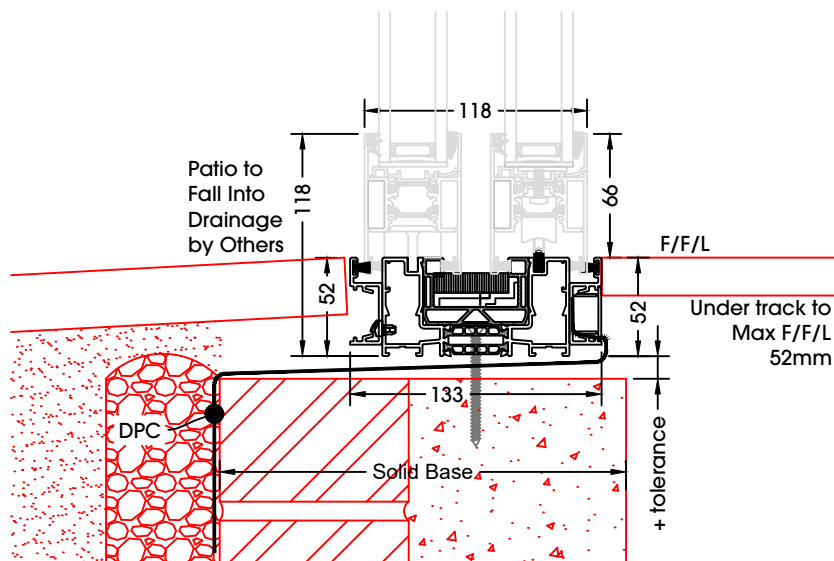

Twin track with flush floor detail inside and outside with plant on panel one end

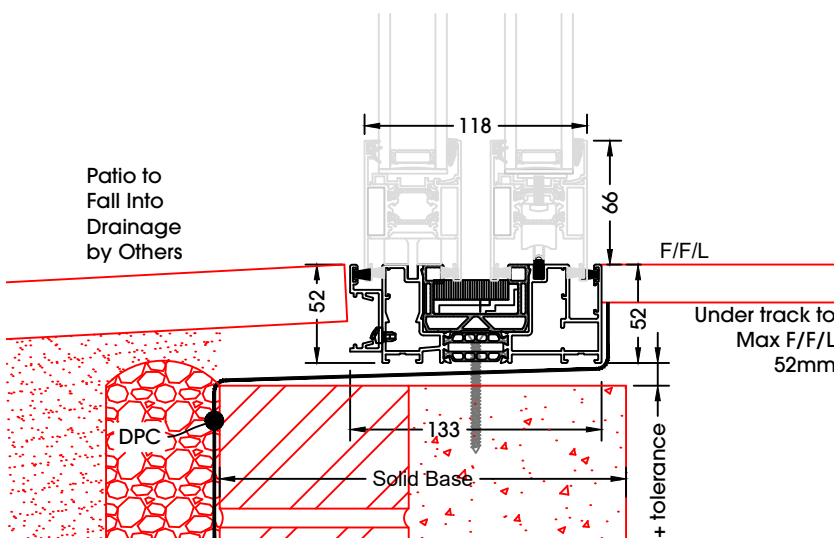
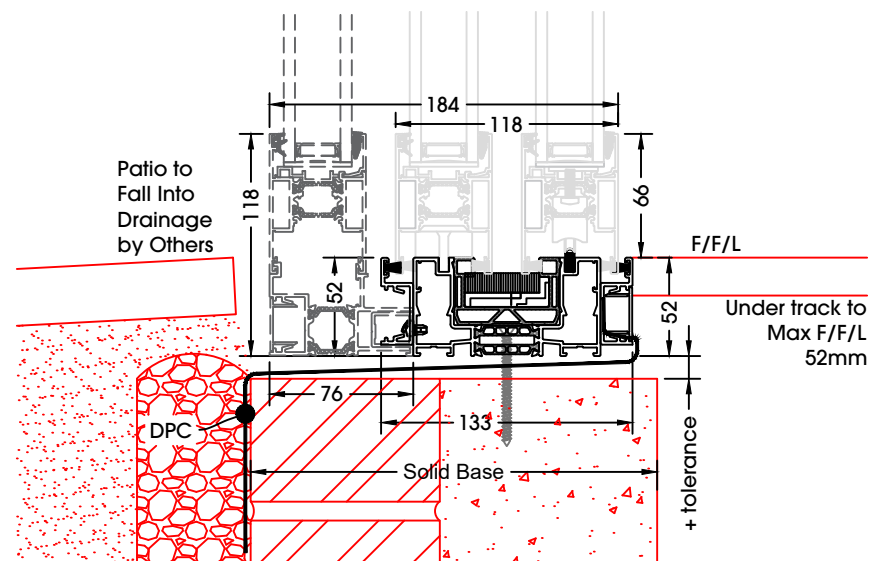

Twin track with flush detail all around and outside flush floor detail with plant on panel one end

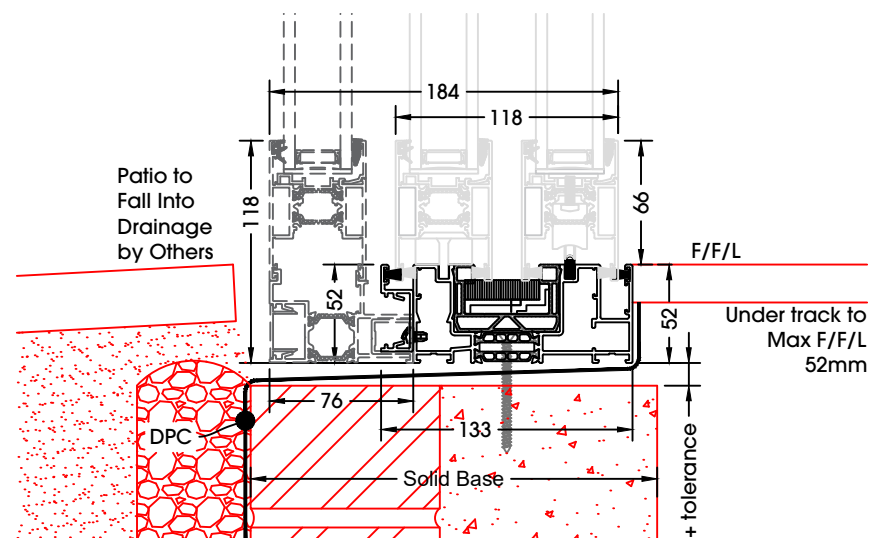

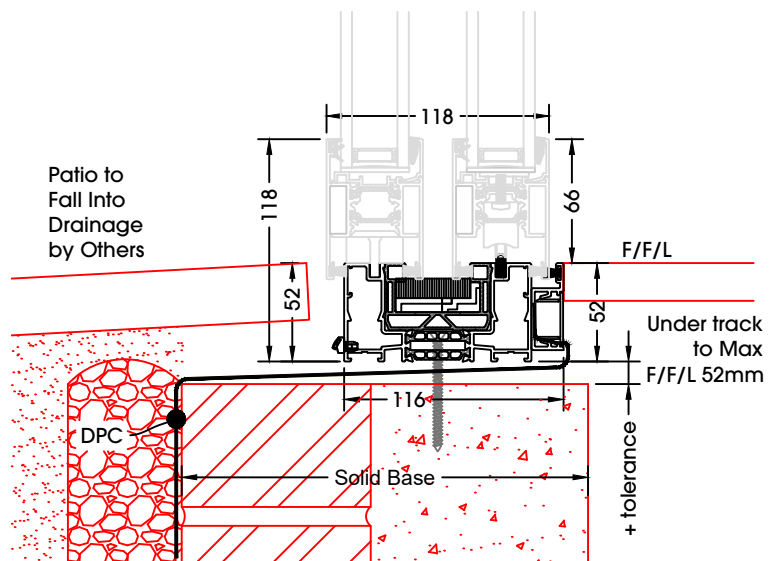

Twin track with flush floor detail inside with plant on panel one end

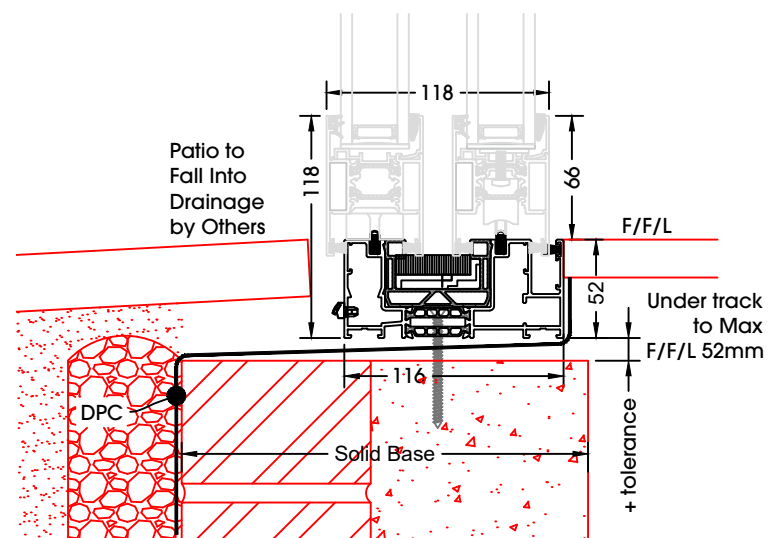
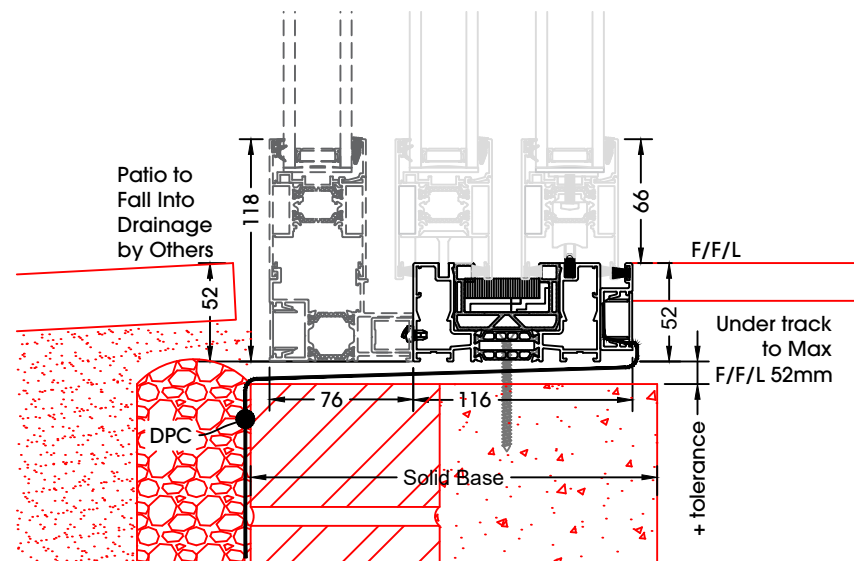

Twin track with flush detail all around with plant on panel one end

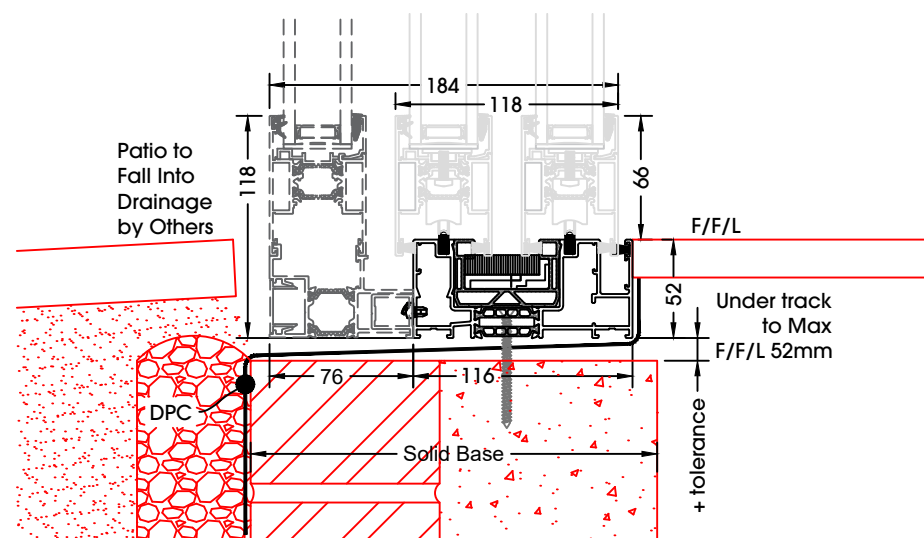

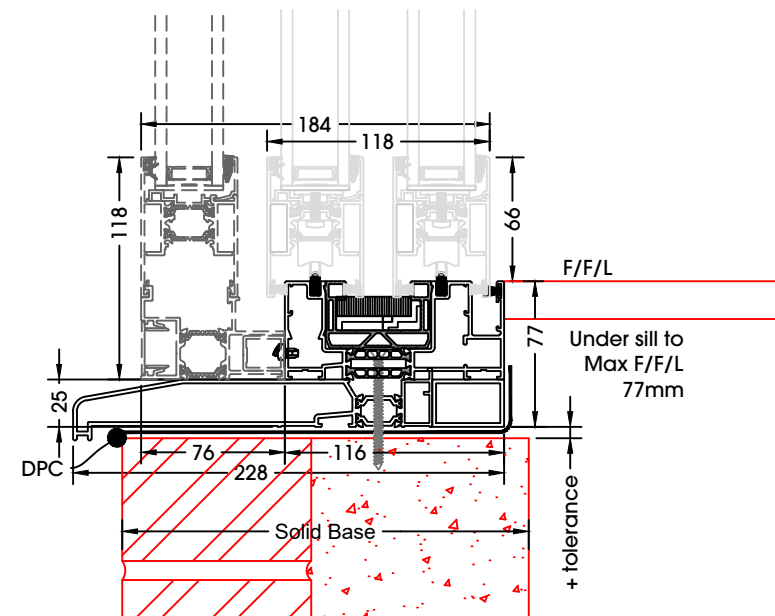
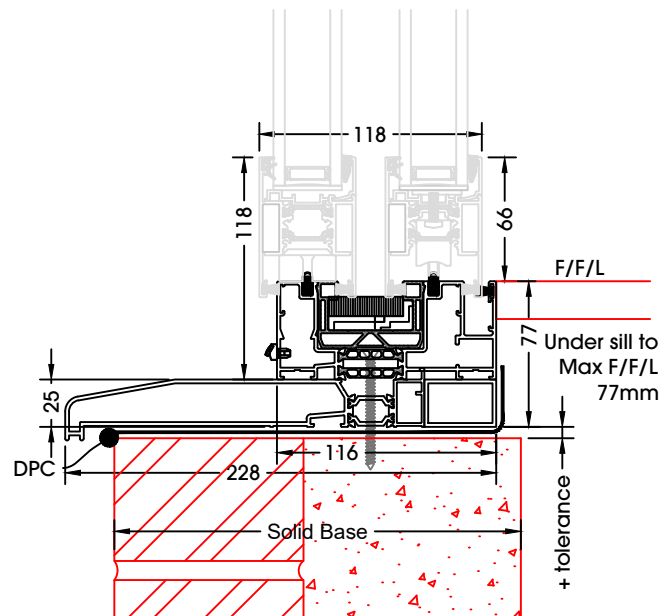

Twin track with flush detail all around with plant on panel one end on a sill



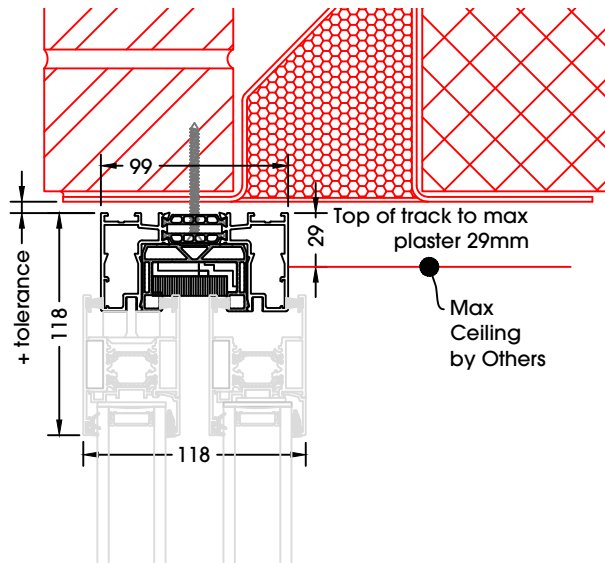

Twin head track

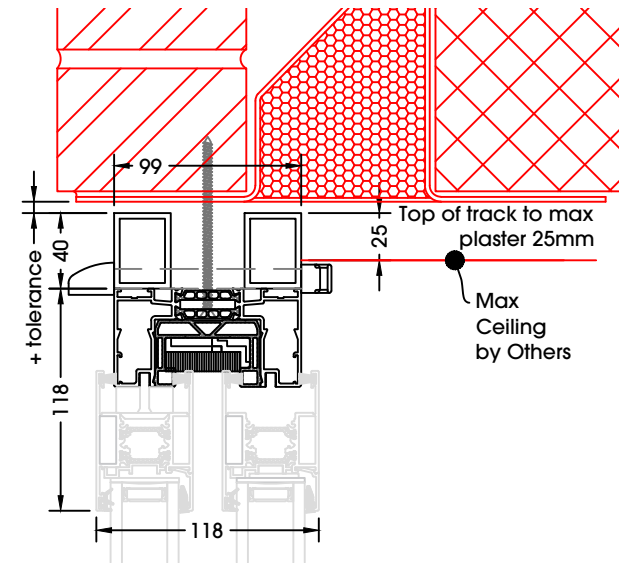

Twin head track with trickle vent

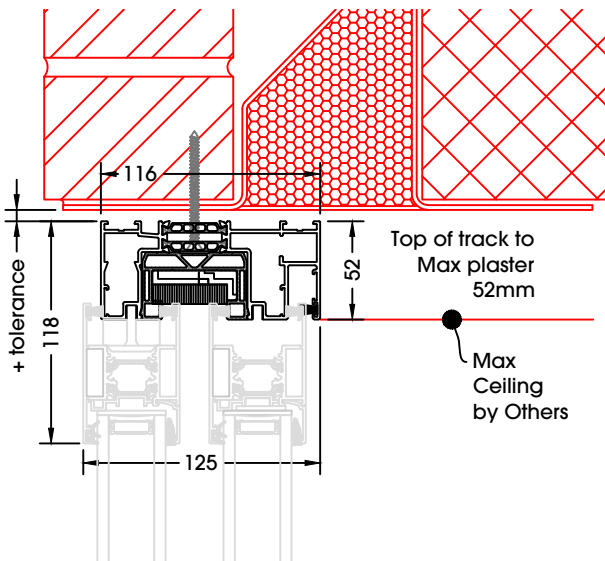

Twin head track with flush track all around

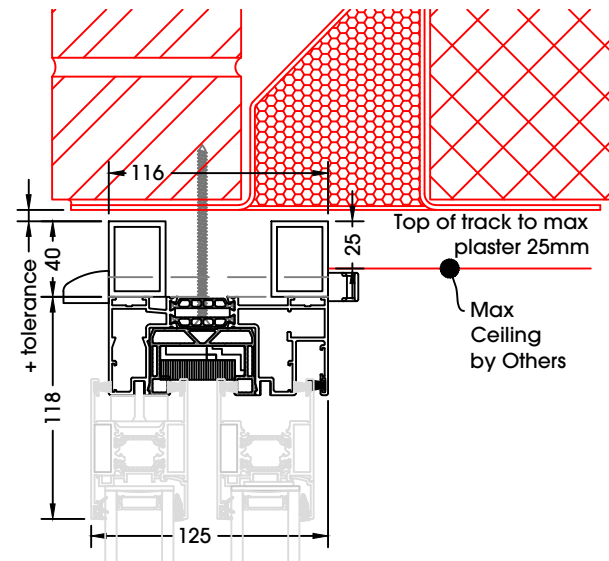

Twin head track with flush track all around with trickle vent

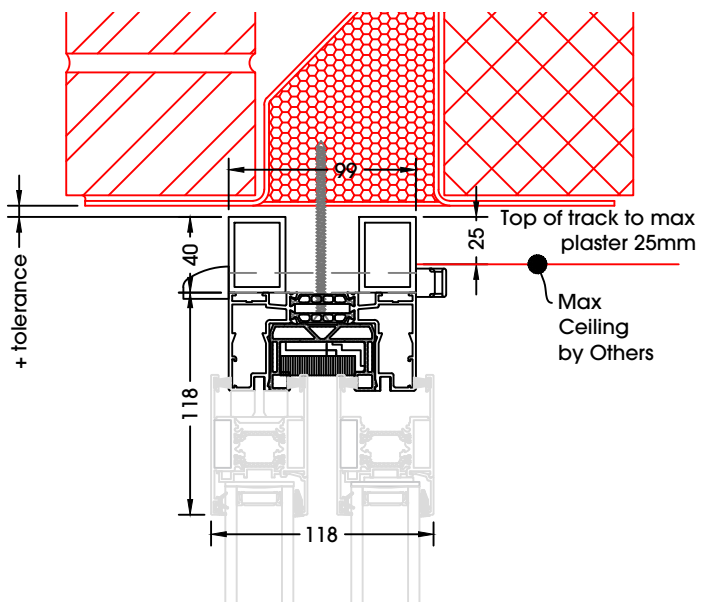

Twin head track with trickle vent and plant-on frame

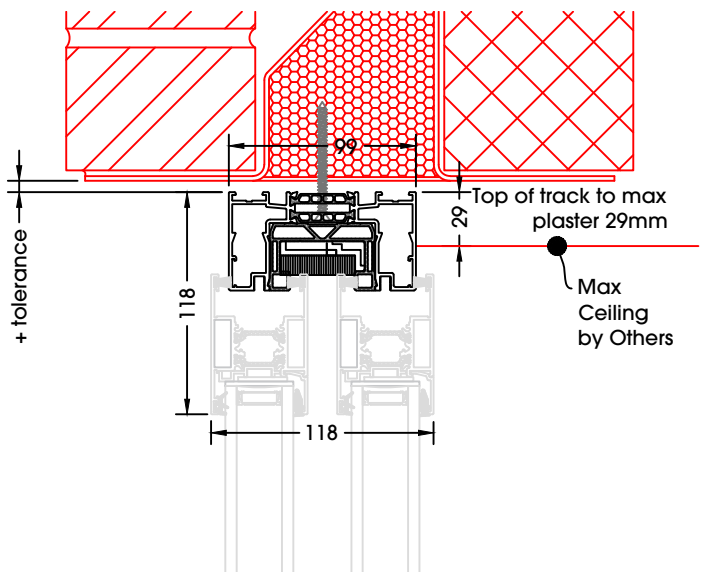
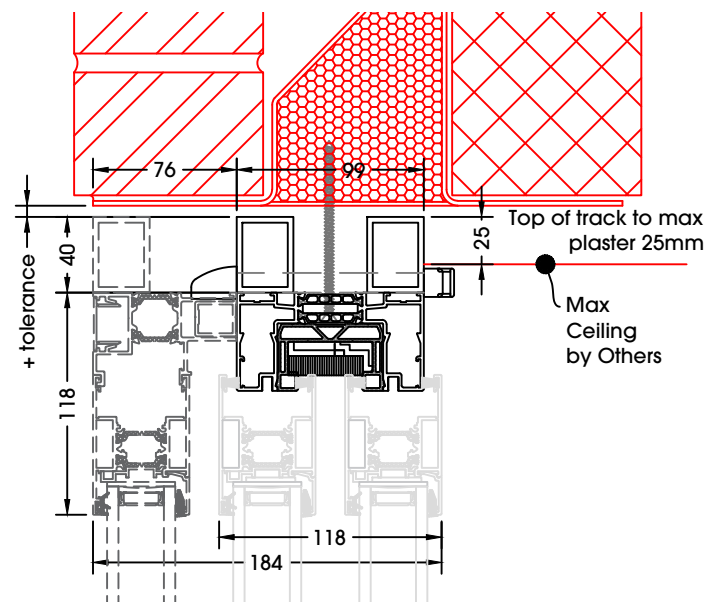

Twin head track with plant-on frame

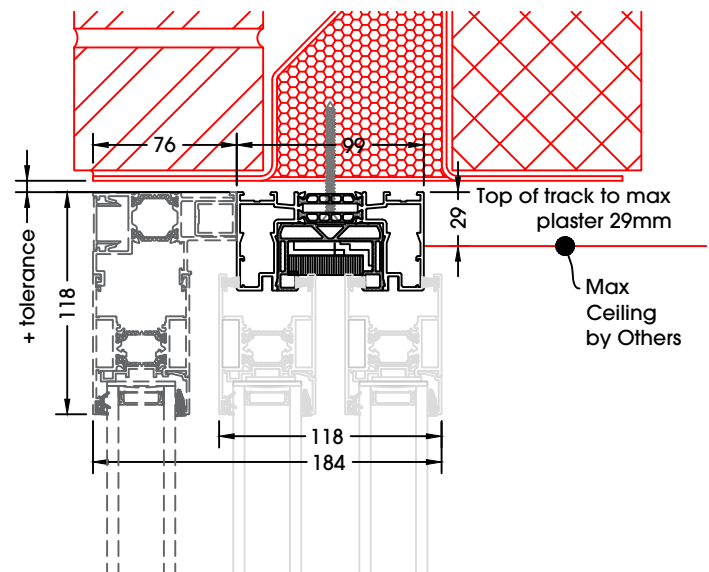

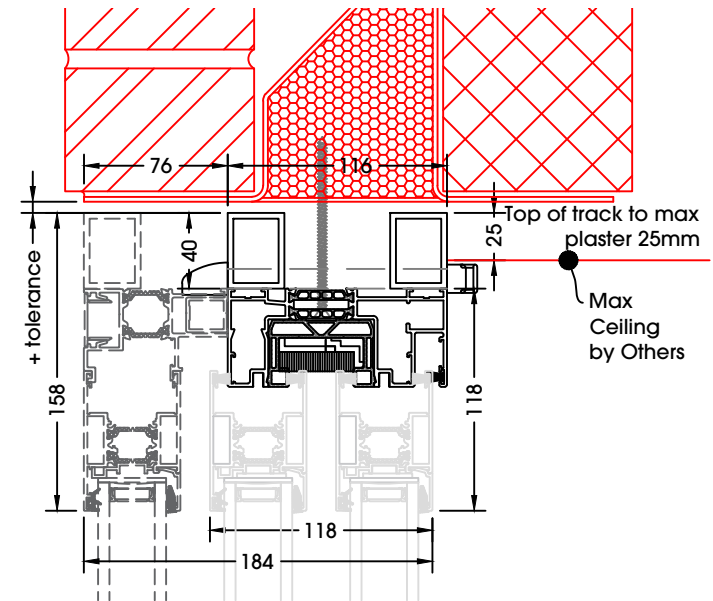
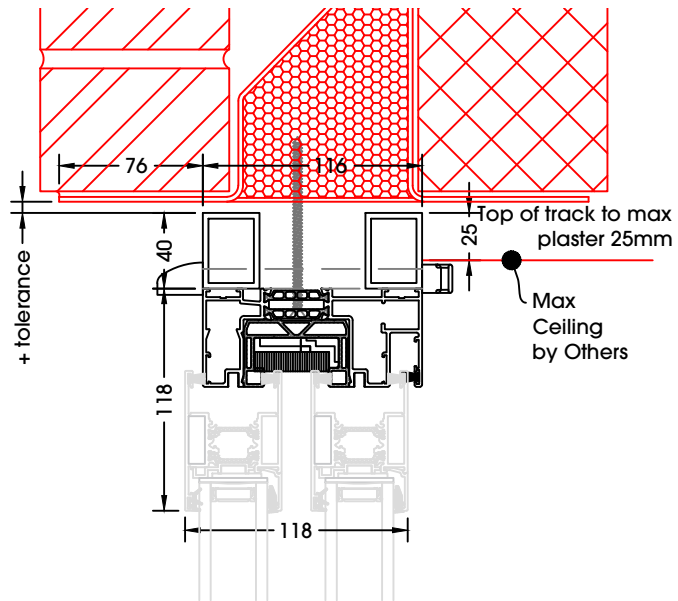

Twin head track with flush track all around with trickle vent and plant-on frame

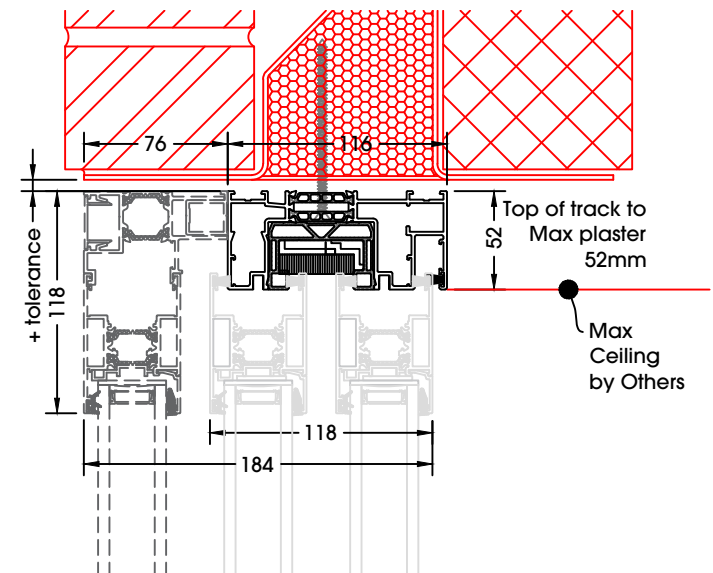
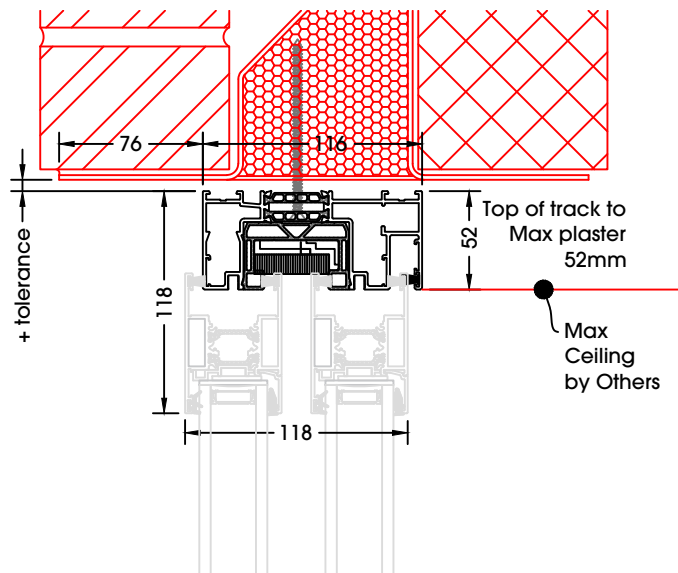

Twin head track with flush track all around with plant-on frame

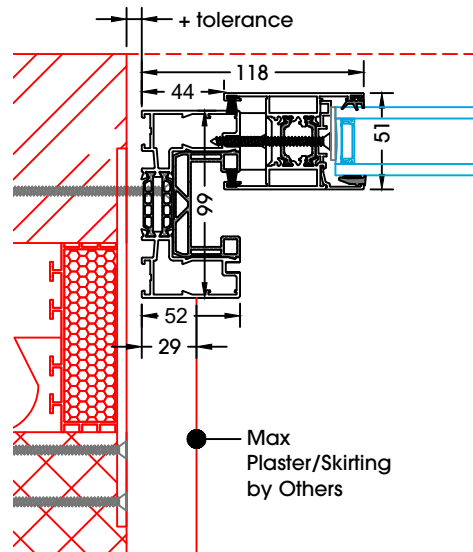

Jamb to wall detail with fixed door on outer track

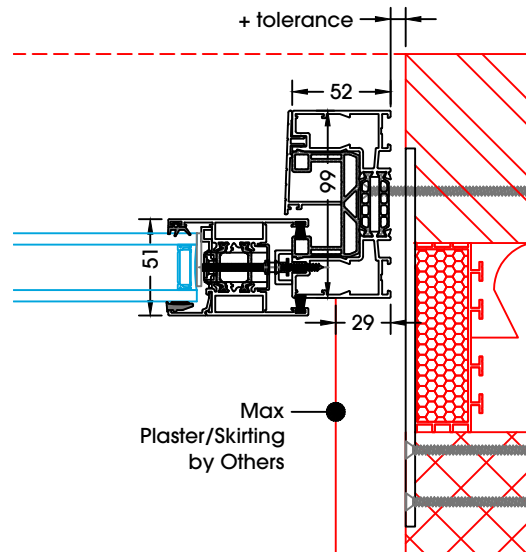

Jamb to wall detail with Sliding door on inner track

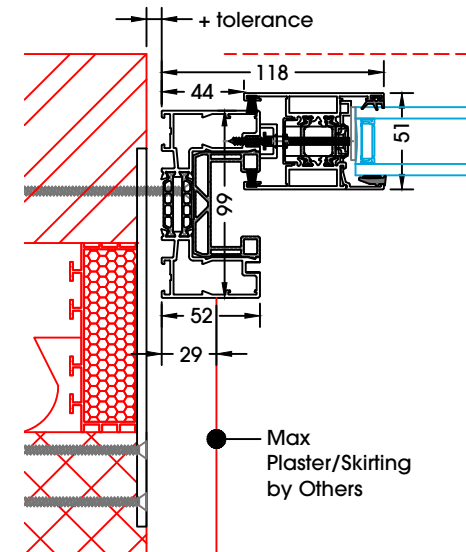

Jamb to wall detail with Sliding door on outer track

Note :-  
No handles shown  
For handles see sheets  
19 & 20

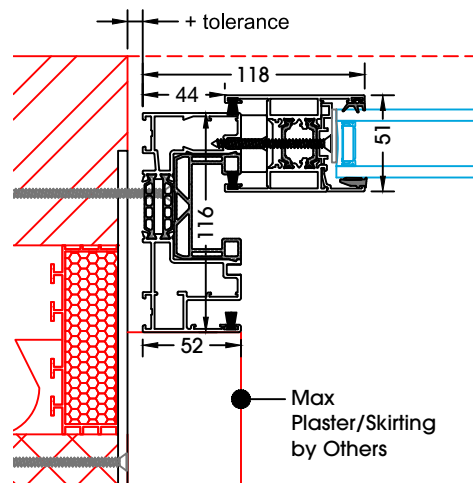

Jamb to wall detail with fixed door on outer track with flush track all round

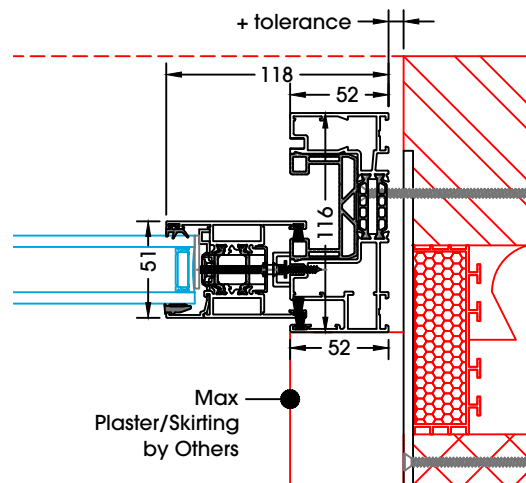

Jamb to wall detail with Sliding door on inner track with flush track all round

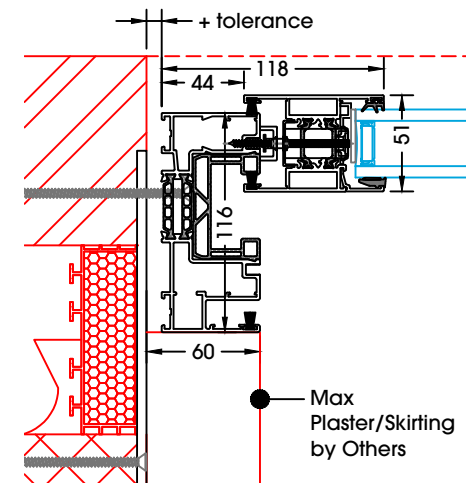

Jamb to wall detail with Sliding door on outer track with flush track all round

Note :-  
No handles shown  
For handles see sheets  
19 & 20

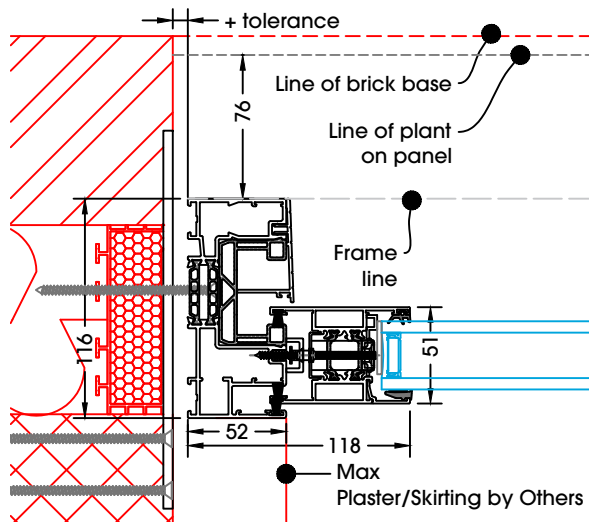

Jamb to wall detail with flush track detail all round with sliding door on inner track and plant-on to outside one end

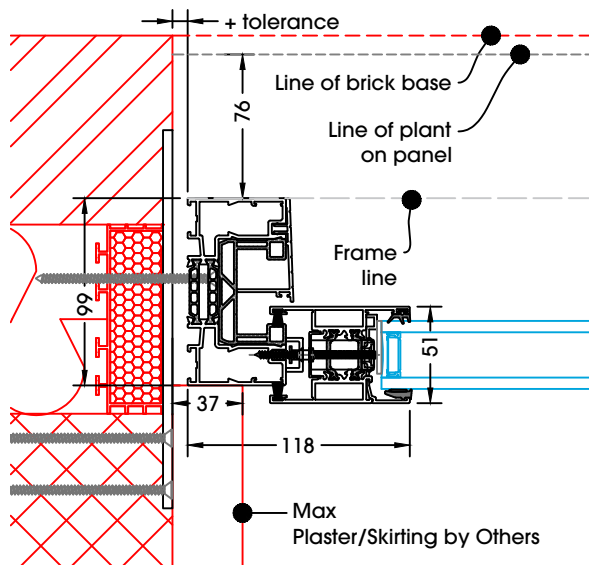

Jamb to wall detail with sliding door on inner track and plant-on to outside one end

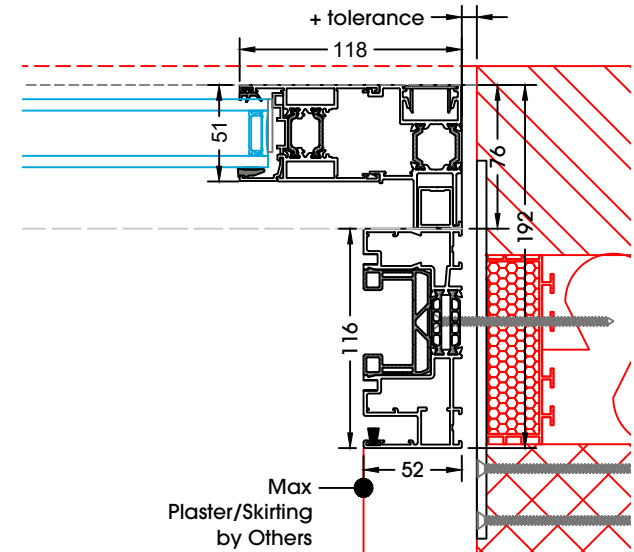
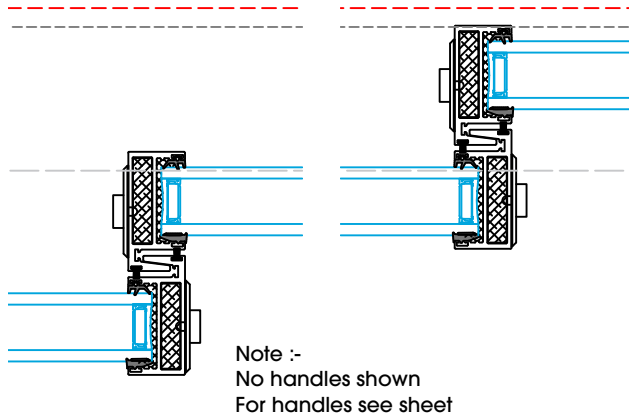

Jamb to wall detail with flush track all round and plant-on to outside one end

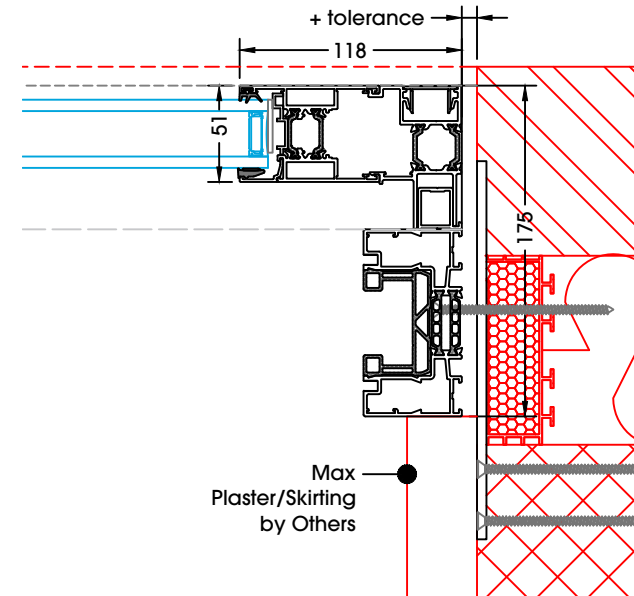

Jamb to wall detail with plant-on to outside one end



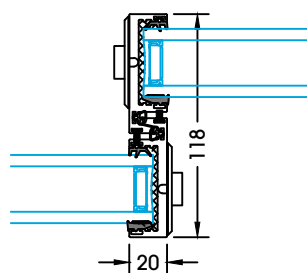

20mm mullion

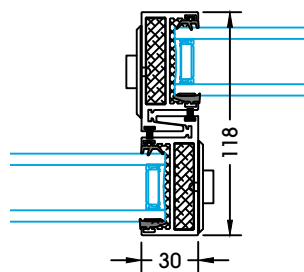

30mm mullion

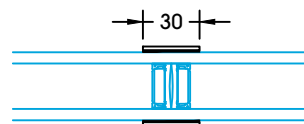

30mm plant-on  
(To be trimmed and  
applied on site)

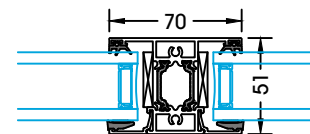

Midrail / transom  
/ mullion detail

Straight Round  
Handle  
Main Panel

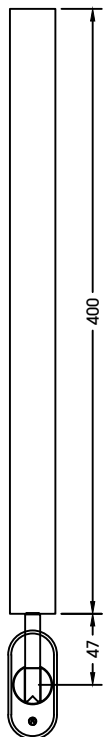

Straight Round  
Handle  
Secondary Panel

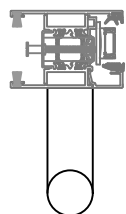
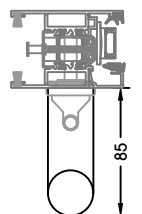
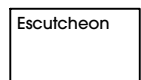
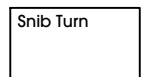

Straight Rectangle  
Handle  
Main Panel



Straight Rectangle  
Handle  
Secondary Panel

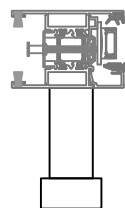
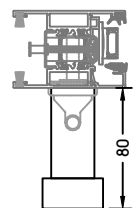
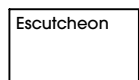
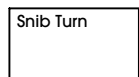
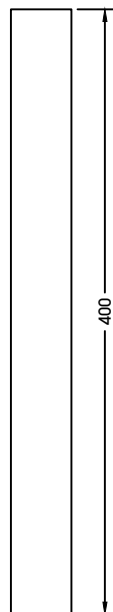

Cranked Round Handle  
Main Panel

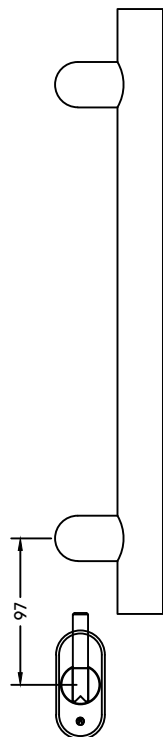

Cranked Round Handle  
Secondary Panel

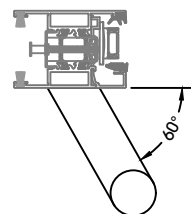
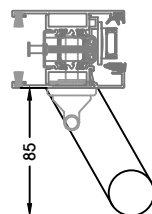
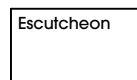
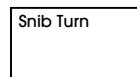
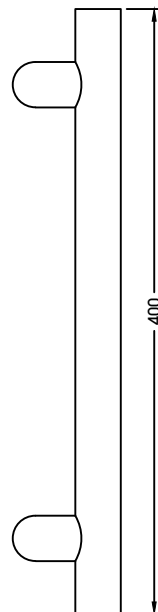

Cranked Rectangle Handle  
Main Panel

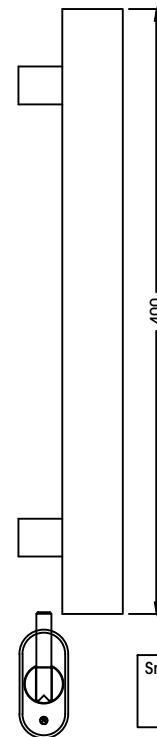

Cranked Rectangle Handle  
Secondary Panel

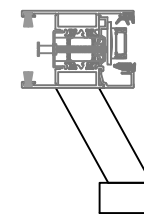
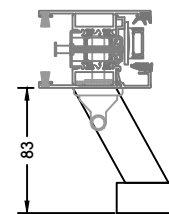
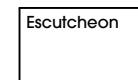
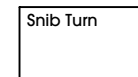
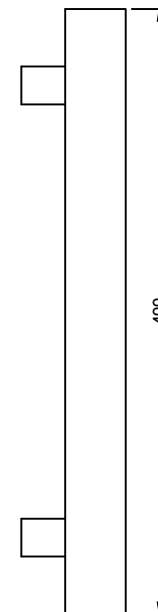

Recessed flush handle  
with lock below

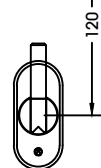
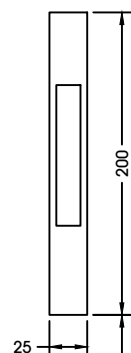

Snib Turn

Escutcheon

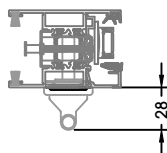

Recessed flush handle  
no lock

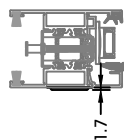
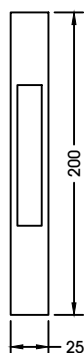

'D' Shaped Handle  
Main Panel

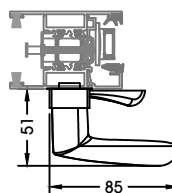
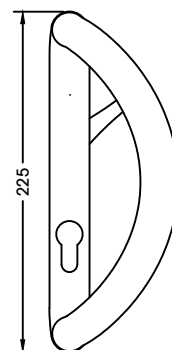

'D' Shaped Handle  
Secondary Panel

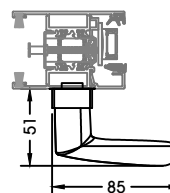
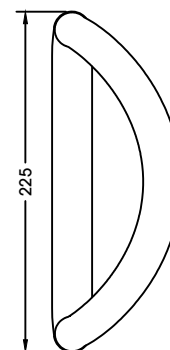

Bifold doors

Sliding doors

Heritage doors

Aluminium windows

Glass roofs

Front doors

Internal glass partitions

Commercial doors

**SUNFLEX UK** 

[sunflexUK.co.uk](https://sunflexUK.co.uk)